

REAR FACE

USE TOOL No. CC1

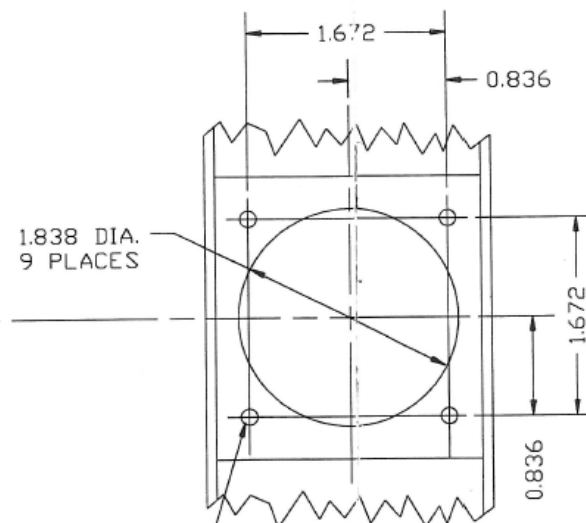

DRILL #22 (.157)
TAP 10-32 - THRU
36 PLACES

USE TOOL No. CC2

VIEW A-A

CYLINDER MOUNTING FACE

DRILL #30 (.128)
TAP 8-32
18 PLACES
FRONT FACE ONLY

BORE 1.838 DIA.
9 PLACES

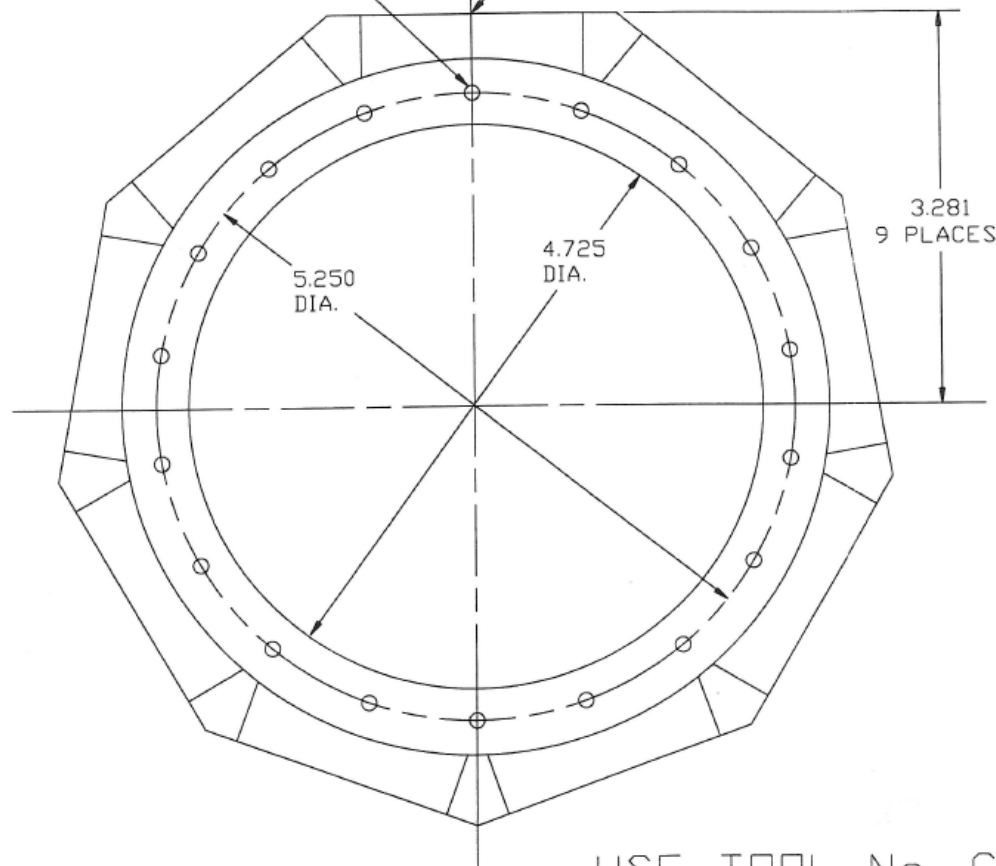

FRONT FACE

USE TOOL No. CC1

